



TORRE 2 / TOWER 2

Planta / Floor **16**

Puerta / Door **C**

SUPERFICIE ÚTIL INTERIOR
INSIDE USABLE AREA

62,44 sqm

SUPERFICIE ÚTIL EXTERIOR
OUTSIDE USABLE AREA

35,57 sqm

SUPERFICIE CONSTRUIDA
(INCLUIDA TERRAZAS)
BUILT AREA (INCL. TERRACE)

113,86 sqm

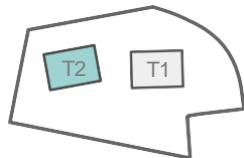
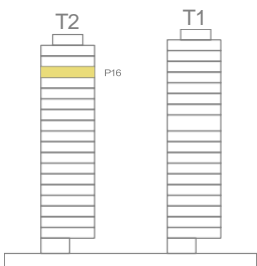
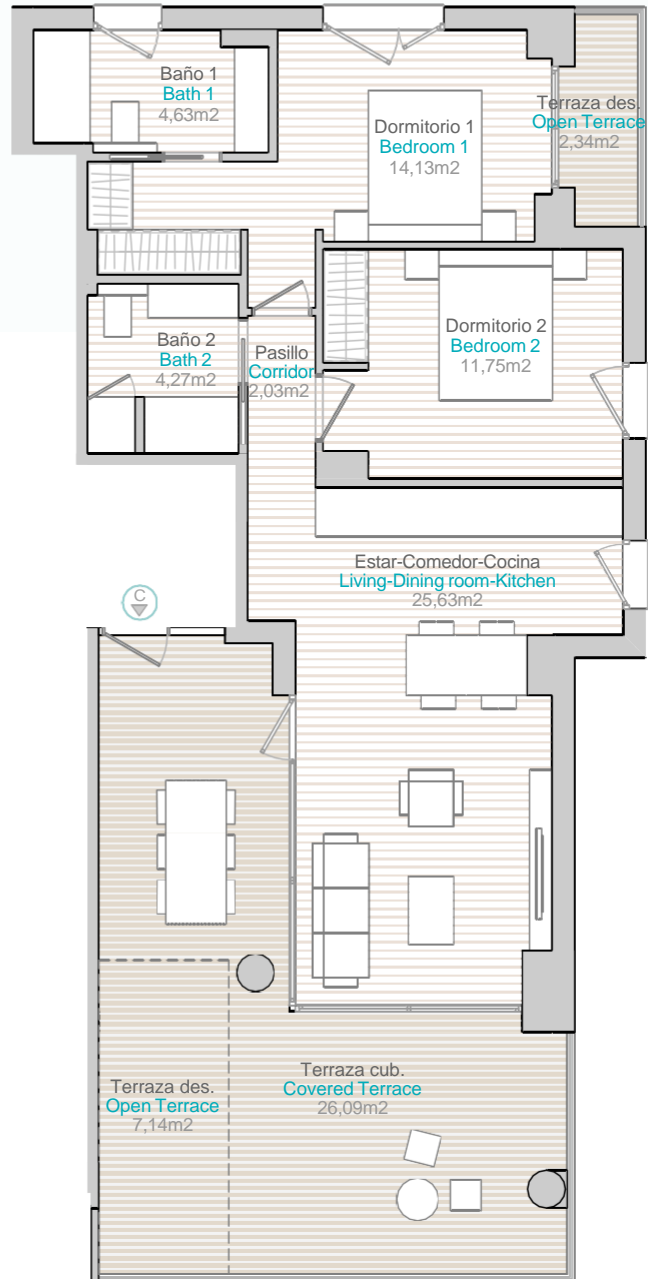

	Grava	op		h = 1.15m		h = 1.80m
	Jardinera	op+v				